

CALIFORNIA KING BED FRAME INSTRUCTIONS

STEP 1

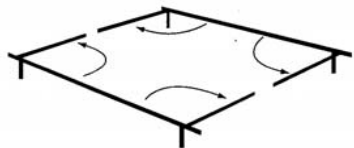

Unfold end rails from under side rail and lay all parts out as shown in overview of frame parts.

STEP 2

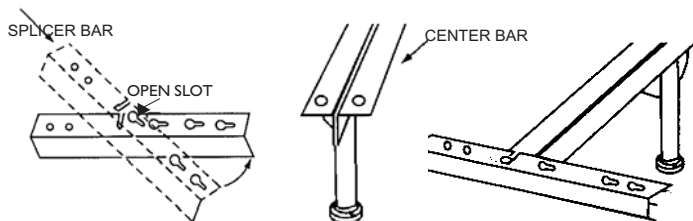

Connect splicer bar to center support by inserting the rivet at the end of the center support bar into the center keyhole slot of the splicer bar, then slipping the open slot on the splicer bar under the rivets on the center bar and swing into place.

STEP 3

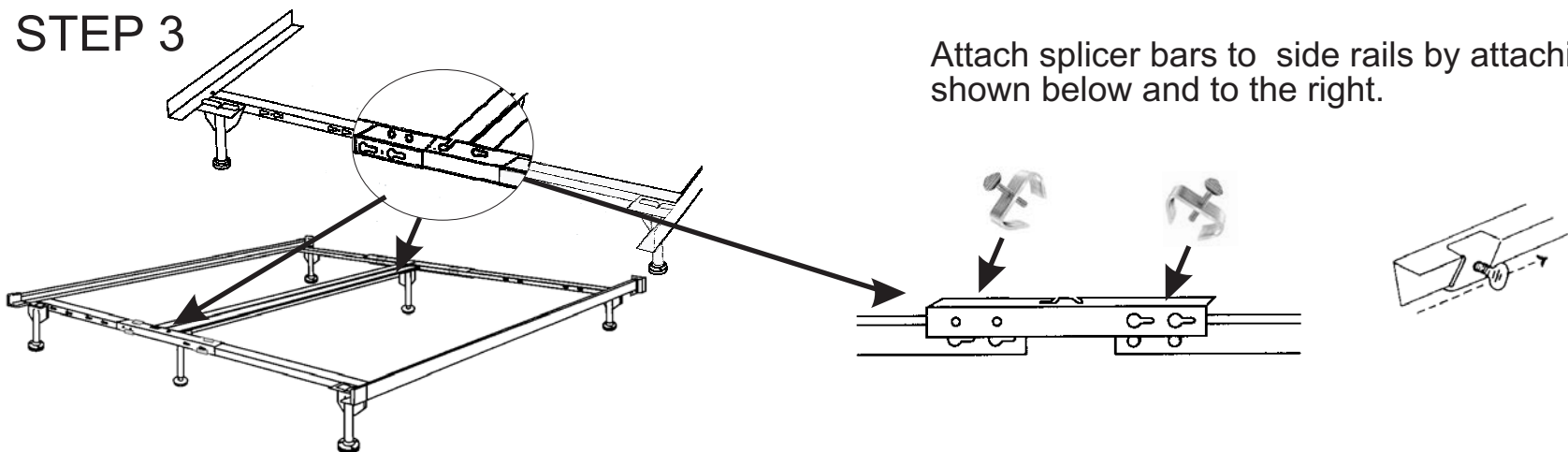

Attach splicer bars to side rails by attaching clamps as shown below and to the right.

STEP 4

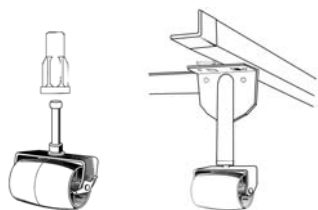

Insert sockets and rug rollers or glides into four corner legs. Insert glides into center support legs.

STEP 5

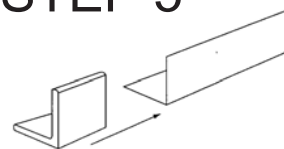

Slip plastic caps over end of side rails.

STEP 6

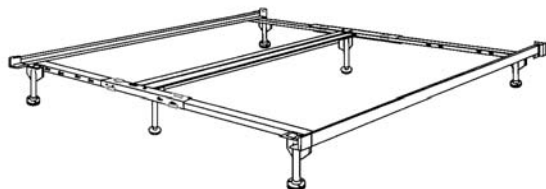

Place frame into desired location. Place bedding on frame.